



FOR SALE
USD\$850,000

Reduced

Kaibo Phase 2, Upgraded Ground Floor Corner Condo w/storage unit



Rare ground floor corner condo located in Phase 2 Kaibo Yacht club Villas, B building. Incredible rental property, right next to Kaibo Restaurant.

Location:

Rum Point

Features:

- 1168 Sq Ft.**
- 2 Bedrooms**
- 2 Bathrooms**
- Beach Front**
- Condominium**
- 2005**



SCAN ME TO FIND OUT MORE

MLS: 417535



Samantha Payne

Sales Associate
samantha.payne@remax.ky

+1 (345) 233 5227

Proud sponsors of





FOR SALE
USD\$850,000

Reduced

Kaibo Phase 2, Upgraded Ground Floor Corner Condo w/storage unit

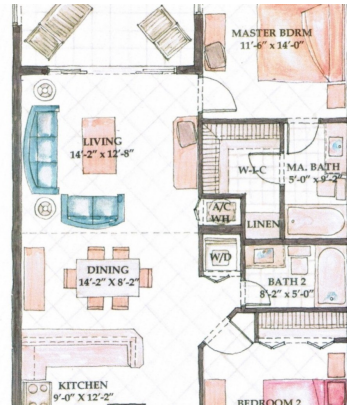

Samantha Payne

Sales Associate
samantha.payne@remax.ky

+1 (345) 233 5227

Proud sponsors of



The information contained herein has been furnished by the owner(s) and/or their nominee and represented by them to be accurate. RE/MAX Cayman Islands, its agents and employees disclaim any liability or responsibility for any inaccuracies, errors, or omissions in the represented information. All the information contained herein is subject to errors, omissions, price changes, prior sale, or withdrawal, without notice and is at all times subject to verification by the purchaser(s).



FOR SALE
USD\$850,000

Reduced

Kaibo Phase 2, Upgraded Ground Floor Corner Condo w/storage unit

Property Details

- BBQ
- Central AC
- Dishwasher
- Hurricane Shutters
- Living Room
- Oven: Electric
- Porch: Screened
- Separate Garage/Space size: 100sqft
- Smart Home Monitoring
- Stove: Electric
- Breakfast
- City Water
- Furnished: Yes
- Kitchen
- Long Term Rentals
- Patio
- Refrigerator
- Septic
- Stories: 1
- Washer/Dryer: Yes
- Cable/Sat TV
- Dining Area
- Garage: 1
- Kitchen area
- Microwave
- Pool
- Separate Garage/Space
- Short Term Rentals
- Storm Windows
- Water Frontage

Additional Information

Aprx Water Frontage	300	Furnished	Yes	Title	Kaibo Phase 2, Upgraded Ground Floor Corner Condo w/storage unit
Class	Existing	Total # of Units	30	Construction	Concrete
Land Certificate	Not Issued	Water Frontage	Yes	Floor Level	1
Stories	1	Foundation	Slab	Strata #	433

Running Costs

Monthly Insurance	CI\$700	Monthly Maintenance Costs	CI\$552.61	TV Costs	CI\$129
Sewage in Maintenance Costs	Yes	AC in Maintenance Costs	No	Gardening in Maintenance Costs	Yes
TV in Maintenance Costs	No	Insurance Included in Maintenance	No	Pest in Maintenance Costs	No



Samantha Payne

Sales Associate
samantha.payne@remax.ky

+1 (345) 233 5227

Proud sponsors of

